

Compact, rugged lathe for on-site re-turning of small shafts or journals

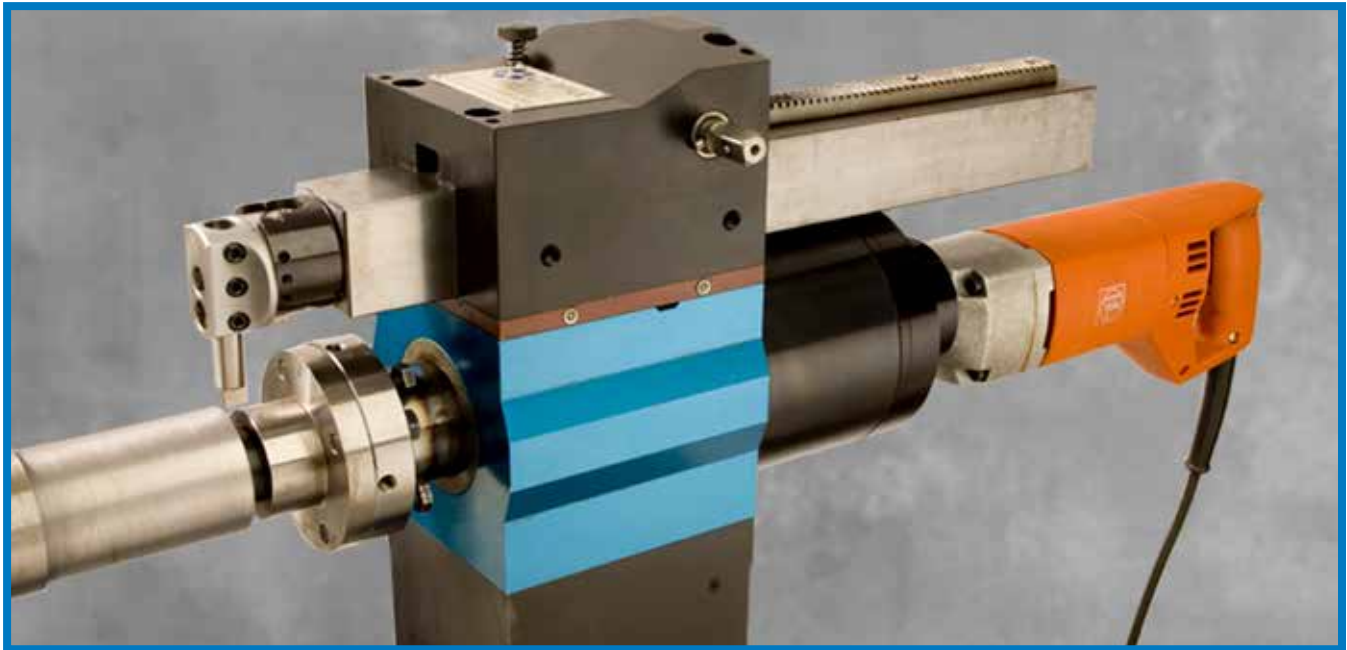

A compact, rugged portable lathe for on-site re-turning of small shafts or journals, the PL2000 Portable Lathe mounts on the end of the shaft.

Compact, powerful, precise.

- The 0.6 Hp (0.45 kW) electric motor and 5.5:1 gear reduction provides plenty of torque. A 1.22 Hp (0.91 kW) pneumatic motor is also available.
- Tool reach up to 12.5 inches (317.5 mm) from end of shaft.
- Criterion style tool head provides accurate depth adjustments in 0.001 inch (0.0254 mm) increments.
- Turns shafts from 1.5 - 9.0 inches (38.1 - 228.6 mm) in diameter. This

compact machine is able to work within a 14 inch (355.6 mm) diameter swing clearance at the end of the shaft.

- Automatic axial feed is infinitely variable from 0 - 0.35 inches/rev. (0 - 8.89 mm/rev.)
- Adjustable tool head and round tool bits allow quick tool positioning for accurate turning.

Quick and easy setup

- Mounts on the end of the shaft. Simply remove the gear or bearing to expose the end of the shaft.
- The PL2000 can be set up by an experienced operator in less than an hour.

Drill and tap four mounting holes on the end of the shaft to attach the mounting flange. (Shafts less than 3.75 inches (95.3 mm) in diameter only need one hole drilled and tapped for the single bolt mounting adapter.) The body of the machine is attached, centered, and aligned in a few minutes.



SPECIFICATIONS

	US	Metric
Machine Performance Ranges		
Turning Reach	12.5 inches	317.5 mm
Shaft dia. maximum		
without optional spacer/counterweight assembly	5.0 inches	127.0 mm
with the optional spacer/counterweight assembly	9.0 inches	228.6 mm
Shaft dia. minimum		
without optional spacer/counterweight assembly	1.5 inches	38.1 mm
Shaft dia. minimum	5.0 inches	127.0 mm
with the optional spacer/counterweight assembly		
Feed rate, automatic (infinitely variable)	0 - 0.035 inches/rev.	0 - 0.89 mm/rev
Cutter modified	1/2 inch (12.7 mm) HSS round lathe tool bit	
Power Options		
Power, electric		
120V, 50/60 Hz or 230V, 50/60Hz	0.66 Hp	0.49 kW
Torque: 40 ft-lbs (53.7 N•m) at 78 rpm bar speed. Bar speed: 52 - 104 rpm max.		
Motor Speed: 110V: 0-109 rpm, 230V: 0-93 rpm. Variable speed control with continuous variable.		
Power, pneumatic	1.22 Hp	0.91 kW
(non-reversing, Hp rated at 200 rpm). Torque: 95 ft-lbs (127.6 N•m) at 55 rpm bar speed. Bar speed: 0 - 96 rpm max.		
Motor speed: 375 rpm no load, 200 rpm full load. Infinitely variable speed control with needle valve.		
Air flow required: 90 psi @ 30 ft ³ /min (620 kPa @ 0.85 m ³ /min).		
Measures		
Overall length, electric		
bar fully retracted	27.0 inches	685.8 mm
bar fully extended	39.0 inches	990.6 mm
Overall length, pneumatic		
bar fully retracted	32.0 inches	812.8 mm
bar fully extended	44.5 inches	1130.3 mm
Overall height	13.75 inches	349.3 mm
without optional spacer/counterweight assembly		
with optional spacer/counterweight assembly	17.75 inches	450.9 mm
Operating weight, electric motor		
without spacers or counterweights	99 lbs	44.9 kg
with spacers and counterweights	116 lbs	52.6 kg
Operating weight, pneumatic motor		
without spacers or counterweights	94 lbs	42.6 kg
with spacers and counterweights	111 lbs	52.3 kg
Shipping weight	190 lbs	86.2 kg
Shipping dimensions L x W x H	26 x 19 x 15 inches	660.4 x 482.6 x 381.0 mm

All dimensions should be considered reference. Contact your CLIMAX Representative for precision dimensions. Specifications are subject to change without notice. There are no systems or components on this machine that are capable of producing hazardous EMC, UV or other radiation hazards. The machine does not use lasers nor does it create hazardous materials such as gasses or dust.

OPERATIONAL DIMENSIONS

Dimensions in Inch (mm)

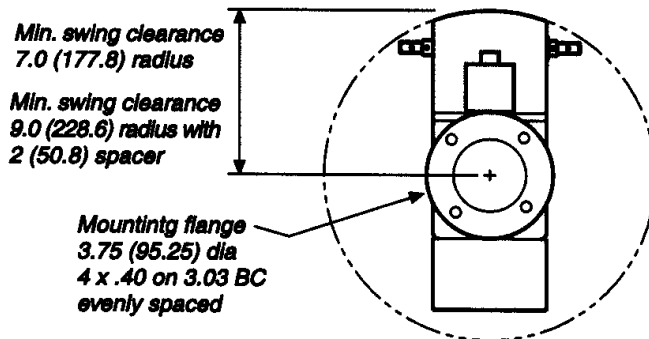
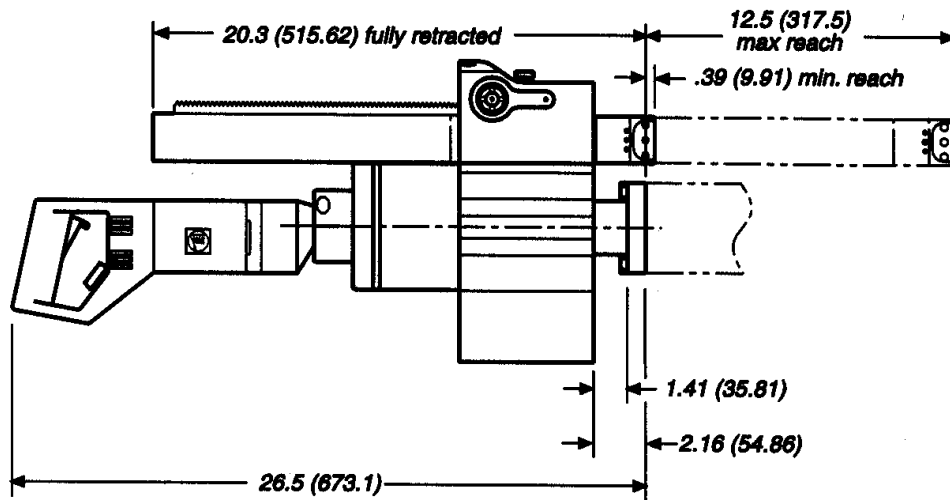

PL2000 with Electric Motor

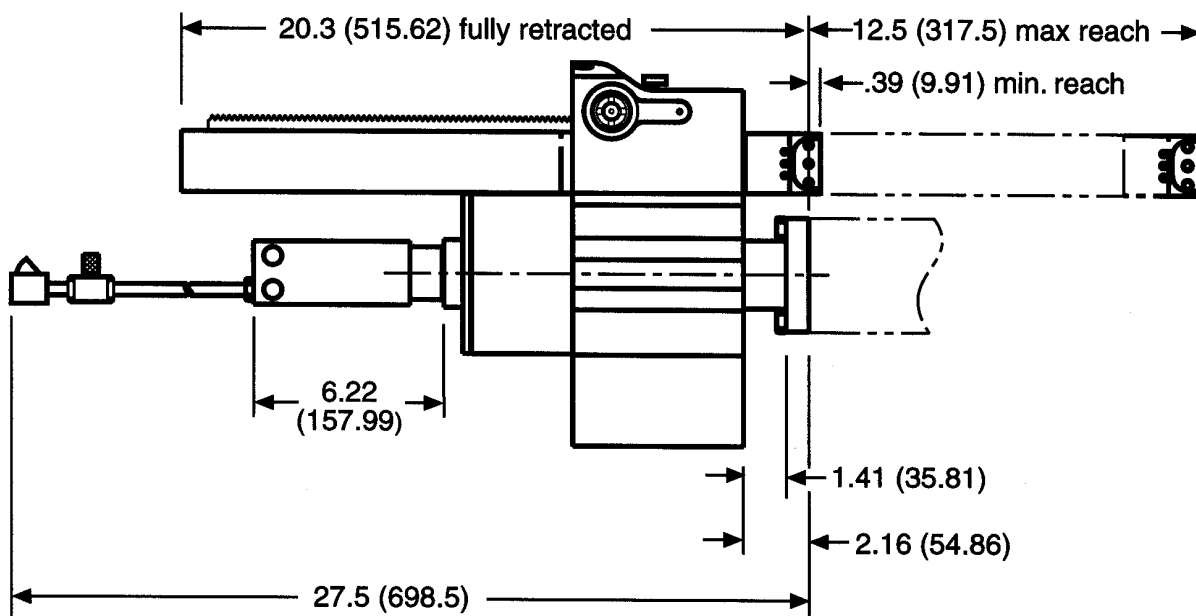

PL2000 with Pneumatic Motor

TOOL CONFIGURATIONS

Select your PL2000 in 5 easy steps.

- 1 Select a Machine Configuration
- 2 Select a Bolt Adapter
- 3 Select a Dial Indicator Assembly
- 4 Select a Spacer Assembly
- 5 Select a Tooling Pack

To configure the lathe you require, select the option you need in each step, then contact your CLIMAX representative.

1 Machine Configuration

PL2000 Portable Lathe, Electric 120 V, 60 Hz **31591**
 Standard PL2000 complete with 0.6 Hp (0.45 kW) electric motor, instruction manual, and tool kit. Shipped in wooden crate. Net weight 99 lb (44.9 kg).

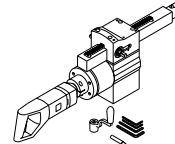

PL2000 Portable Lathe, Electric 230 V, 50 Hz **31593**
 As above, with 230 V, 50 Hz Motor.

PL2000 Portable Lathe, Pneumatic **31584**
 Standard PL2000 complete with 1.22 hp (.91 kW) pneumatic motor, instruction manual, tool kit and pneumatic conditioning unit. Shipped in wooden crate. Net weight 94 lb (42.7 kg).

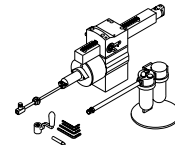

PL2000 Portable Lathe, Pneumatic, CE Compliant **31584CE**
 As above with CE approved pneumatic connection package with emergency air shutoff valve assembly.

2 Bolt Adapter

Single bolt mount adapter **30572**
 Allows attachment of the PL2000 to the end of the shaft with one bolt. Recommended for shafts under 3.75 inches (95.3 mm) in diameter.

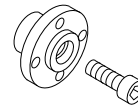

3 Dial Indicator Assembly

Dial Indicator Assembly **30407**
 Attaches to tool head for accurately aligning the machine.

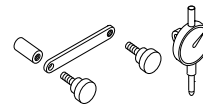

4 Spacer Assembly

Spacer assembly **31590**
 Spacer and counterweight assembly. Allows the PL2000 to turn 5.0 - 9.0 inches (127.0 - 228.6 mm) diameter shafts. Includes all mounting hardware.

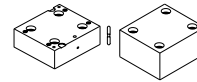

5 Tooling Pack

Tooling Pack (not shown) **37810**
 One ½ inch x 3.0 inch (12.7 mm x 76.2 mm) grooving/plunging tool bit, and one HSS ½ inch x 3.0 inch (12.7 mm x 76.2 mm) finishing tool bit in storage case.

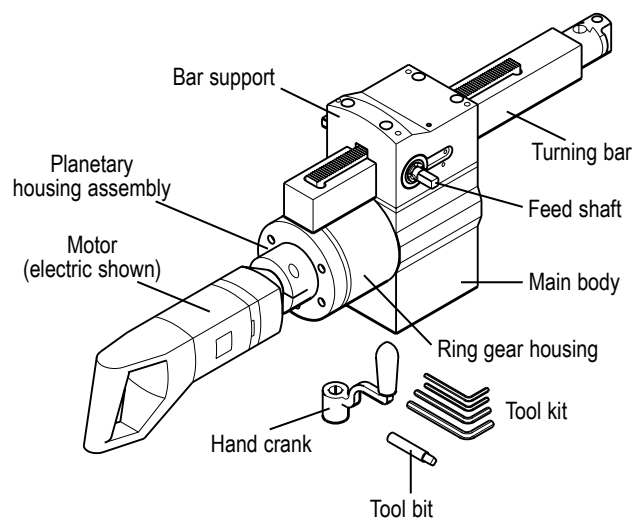

OEM PROFESSIONAL OPERATIONAL TRAINING



Backed by Over 50 Years of Experience

CLIMAX pioneered the concept of portable machine tools in 1964. Since that time, CLIMAX has grown to become the world's largest provider of innovative on-site machining solutions.

Professional, Experienced Instructors

All training programs are taught by experienced OEM CLIMAX trainers. Your instructor will provide valuable information on operator safety, tool set-up, mounting, and operation that will help you complete your on-site machining tasks quickly and to the highest quality standards.



Typical Courses Include:

- ✓ Operator safety
- ✓ Tool component review and setup
- ✓ Standard operational techniques
- ✓ Overview of cutting tools and recommend usage
- ✓ Maintenance procedures
- ✓ A certificate of achievement - issued to each student immediately following course completion

Sign up today for training at one of our **seven** Global CLIMAX training centers.

- Portland, Oregon
- Houston, Texas
- Baton Rouge, Louisiana
- Cleveland, Ohio
- Manchester, United Kingdom
- Düren, Germany
- Dubai, United Arab Emirates



CLIMAX GLOBAL LOCATIONS

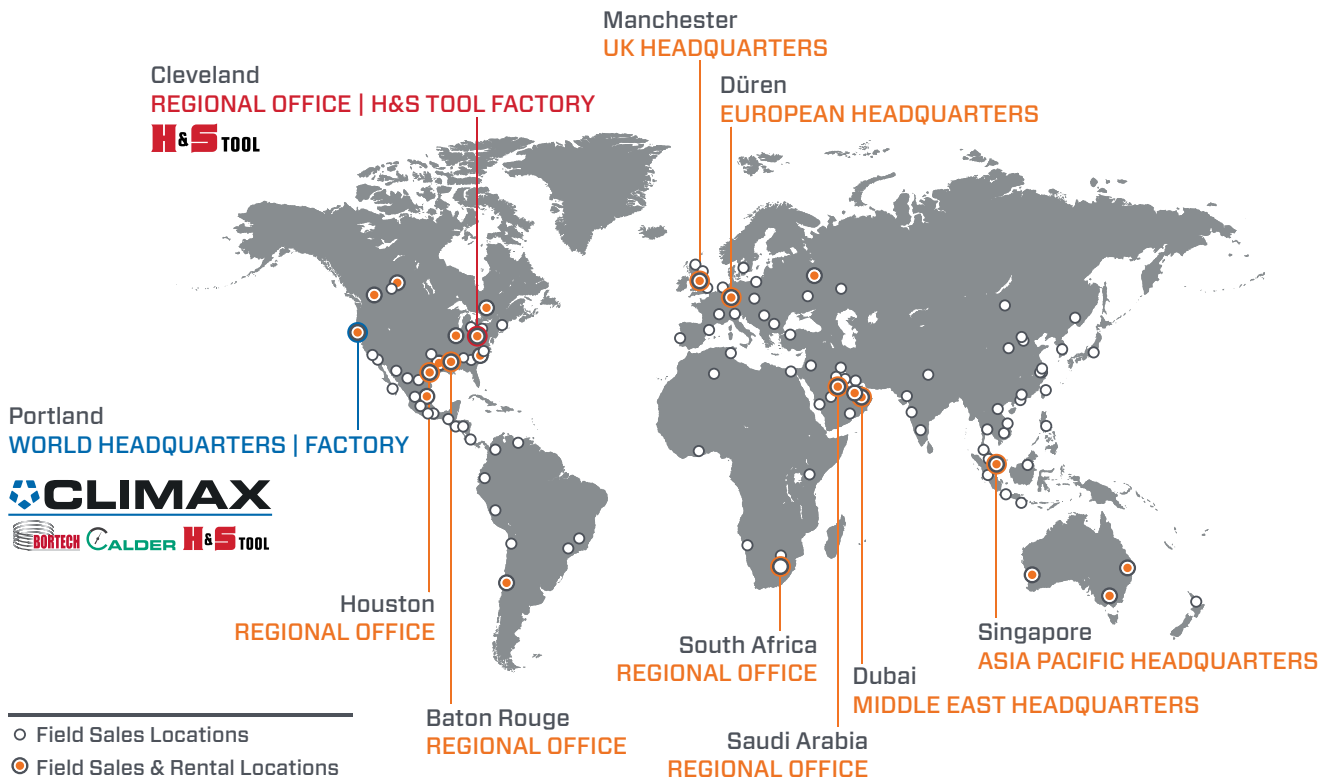

Call CLIMAX for:

RENTALS

On selected models. With 20+ worldwide rental depot locations, you are never far away from CLIMAX.

OEM TRAINING



If you need training or on-site consultation, we're famous for it!

SPARES, REPAIR & MAINTENANCE

Call us for anything you need to keep your system running in top condition.

CUSTOM PROJECTS

Custom turn-key system design services from the most experienced engineers in the business!

Connect with us:  

World Headquarters

CLIMAX | BORTECH | CALDER Factory
Address: 2712 E. 2nd St, Newberg, Oregon 97132
Tel: +1 503 538 2185
Fax: +1 503 538 7600
Email: info@cpmt.com

Regional Office - Cleveland

H&S TOOL Factory
Address: 715 Weber Dr., Wadsworth, Ohio 44281
Tel: +1 330 336 4550
Email: info@hstool.com

Asia Pacific

Address: 308 Tanglin Rd #02-01, Singapore 247974
Tel: +65 6801 0662
Fax: +65 6801 0699
Email: ClimaxAsia@cpmt.com

European

Address: Am Langen Graben 8, 52353 Düren, Germany
Tel: (+49) (0) 2421 9177 0
Fax: (+49) (0) 2421 9177 29
Email: ClimaxEurope@cpmt.com

Middle East

Address: Warehouse #5, Plot: 369 272, Um Sequim Road, Dubai, UAE
Tel: +971 4 321 0328
Email: ClimaxUAE@cpmt.com

United Kingdom

Address: Unit 7 Castlehill Industrial Estate, Bredbury Industrial Park, Horsfield Way, Stockport SK6 2SU
Tel: +44 (0) 161 406 1720
Email: ClimaxUK@cpmt.com